

NOTICE!!

These documents have been scanned!

Do not place un-scanned documents beneath this notice!

Do not remove this notice from this file!

GPO Jacket No. 560-102
Print Order 61540
Rise Business Services, LLC
Job=AZ15 5/21/2019



Box Number= AZ15075



Claim Begin-End: AMC452456-AMC452456

1 Initial Receipt



AZ15075-7

AMC452444-AMC452831

United States Department of the Interior
Bureau of Land Management
 DIV OF LANDS, MINRLS & ENERGY
 ONE N CENTRAL AVE
 PHOENIX, AZ 85004 -4427
 Phone: 602-417-9200

Receipt

No: 4307382

Transaction #: 4423694	
Date of Transaction: 11/15/2018	
CUSTOMER:	
DESTINY RESOURCES LLC 4493 E WHITEHALL DR SAN TAN VALLEY, AZ 85140-6797 US	

ENTERED
 NOV 26 2018
 BY: *[Signature]*

LINE #	QTY	DESCRIPTION	REMARKS	UNIT PRICE	TOTAL
1	1.00	LOCATABLE MINERALS / MINING CLAIMS-NEW, UNADJUD, ONE OR MORE AUTH NOS / NEW MINING CLAIM PROCESSING FEE CASES: AMC452456/\$20.00		- n/a -	20.00
2	1.00	LOCATABLE MINERALS / MINING CLAIMS-NEW, UNADJUD, ONE OR MORE AUTH NOS / NEW MINING CLAIMS LOCATION FEE CASES: AMC452456/\$37.00		- n/a -	37.00
3	1.00	LOCATABLE MINERALS / MINING CLAIMS-NEW, UNADJUD, ONE OR MORE AUTH NOS / NEW MINING CLAIMS MAINTENANCE FEE CASES: AMC452456/\$155.00		- n/a -	155.00
TOTAL:					\$212.00

PAYMENT INFORMATION			
1	AMOUNT:	212.00	POSTMARKED: N/A
	TYPE:	CHECK	RECEIVED: 11/15/2018
	CHECK NO:	2352	
	NAME:	SNIDER, TRAVIS 16231 E BAINBRIDGE AVE FOUNTAIN HILLS AZ 85268 US	

REMARKS

This receipt was generated by the automated BLM Collections and Billing System and is a paper representation of a portion of the official electronic record contained therein.

NOTICE!!

These documents have been scanned!

Do not place un-scanned documents beneath this notice!

Do not remove this notice from this file!

GPO Jacket No. 560-102
Print Order 61540
Rise Business Services, LLC
Job=AZ15 5/21/2019



Box Number= AZ15075



Claim Begin-End: AMC452456-AMC452456

2 Correspondence



AZ15075-7 AMC452444-AMC452831

**NO
DOCUMENTS
FOUND**

NO DOCUMENTS FOUND
NO DOCUMENTS FOUND

NOTICE!!

These documents have been scanned!

Do not place un-scanned documents beneath this notice!

Do not remove this notice from this file!

GPO Jacket No. 560-102
Print Order 61540
Rise Business Services, LLC
Job=AZ15 5/21/2019



Box Number= AZ15075



Claim Begin-End: AMC452456-AMC452456

3 Transfers



AZ15075-7

AMC452444-AMC452831

**NO
DOCUMENTS
FOUND**

NO DOCUMENTS FOUND
NO DOCUMENTS FOUND

NOTICE!!

These documents have been scanned!

Do not place un-scanned documents beneath this notice!

Do not remove this notice from this file!

GPO Jacket No. 560-102
Print Order 61540
Rise Business Services, LLC
Job=AZ15 5/21/2019



Box Number= AZ15075



Claim Begin-End: AMC452456-AMC452456

4 Annual Filings



AZ15075-7 AMC452444-AMC452831

**NO
DOCUMENTS
FOUND**

NO DOCUMENTS FOUND
NO DOCUMENTS FOUND

NOTICE!!

These documents have been scanned!

Do not place un-scanned documents beneath this notice!

Do not remove this notice from this file!

GPO Jacket No. 560-102
Print Order 61540
Rise Business Services, LLC
Job=AZ15 5/21/2019



Box Number= AZ15075



Claim Begin-End: AMC452456-AMC452456

5 Miscellaneous



AZ15075-7

AMC452444-AMC452831

**NO
DOCUMENTS
FOUND**

NO DOCUMENTS FOUND
NO DOCUMENTS FOUND

NOTICE!!

These documents have been scanned!

Do not place un-scanned documents beneath this notice!

Do not remove this notice from this file!

GPO Jacket No. 560-102
Print Order 61540
Rise Business Services, LLC
Job=AZ15 5/21/2019



Box Number= AZ15075



Claim Begin-End: AMC452456-AMC452456

6 Location Notices-Amendments and Supporting Documents



AZ15075-7 AMC452444-AMC452831

MINING CLAIM STATUS REPORT

Data Entered: 11/26/2018

MTP Checked By: _____

GEO Checked By: _____

LEAD SERIAL NUMBER: AMC 452454 thru AMC 452456

NUMBER OF CLAIMS & TYPE:

1 LODE
 _____ PLACER
 _____ ASSOCIATION PLACER
 _____ MILL SITE
 _____ TUNNEL SITE

CHARGES:

Processing Fee @ \$20 = \$ 20
 Location Fee @ \$37 = \$ 37
 Maintenance Fee @ \$155 = \$ 155
 Add'l Maint Fee for Assoc Placer = \$ _____
SUBTOTAL \$ _____
 Other Fees \$ _____
 Other Fees \$ _____
TOTAL \$ 212

TOTAL ACREAGE: _____ Per Claim
(Placer Only)

NUMBER OF LOCATORS: _____

DOCUMENTS RECEIVED VIA : Over-the-Counter [] Mail [] TIMELY FILED: Yes [] No []

LEGAL DESCRIPTION: T 13S R 6W SEC 15
 T _____ R _____ SEC _____
 T _____ R _____ SEC _____
 T _____ R _____ SEC _____
 T _____ R _____ SEC _____

BLM [] FOREST SERVICE [] _____ SUBJ TO PL 359: Yes [] No []
WILDERNESS AREA [] _____

SPLIT ESTATE: N/A [] SX [] PX [] OTHER [] _____
SRHA [] Was proper Notice filed if located on SHRA Land? Yes [] No []

RECONVEYED MINERALS ON BLM LAND REQUIRE OPENING ORDER FROM 1944 TO 1993:
Open to Entry On _____ N/A []

COMMENTS/STATUS: VOID [] PARTIALLY VOID [] PVT MINERALS [] WITHDRAWN LANDS []
OTHER [] _____

[] Claimant acknowledges that portions of the following claim(s) site(s) may be void or voidable.

Printed Name of Claimant _____ Signature of Claimant _____

*****FINAL ADJUDICATION*****

DATE _____ INITIALS _____

AMC 452456

Please record the mining claim CG#117.

When recorded could you please send to:

Destiny Resources LLC
C/O Dave Cousins
3-58 Simpson Rd.
St. Catharines, ON L2N 0A5

If you are unable to send to a Canadian you may send to:

Travis Snider
16231 East Bainbridge Avenue
Fountain Hills, AZ 85268

Thank you

PHOENIX, ARIZONA

NOV 14 P 2:52

RECEIVED
BLM AZ STATE OFFICE

When recorded, please return

Destiny Resources LLC

4493 E. Whitehall Drive - C/O Dave Cousins
San Tan Valley, AZ 85140 - 3-58 Simpson Rd.
St. Catharines, ON L2N 0A5

LOCATION NOTICE FOR LODE MINING CLAIM

NOTICE IS HEREBY GIVEN that the: CG#117
_____ lode mining claim has been located
by Destiny Resources LLC whose current mailing
address is 4493 E Whitehall Drive
San Tan Valley, AZ 85140

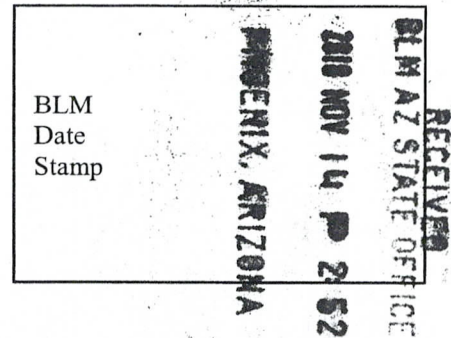

The general course of this claim is North to South and it is situated in Pima
County, Arizona. This claim is 1500 feet in length and 600 feet in width. This claim
runs from the location monument on which this location notice is posted approximately at Latitude: _____
32°17'52.51"N Longitude: 112°52'25.91"W. This claim is marked by six
monuments, one at each corner and one at the center of each end line of the claim.

The location monument on which this notice is posted is situated within Section 15,
Township 13 S, Range 6 W, Gila Salt River Base and Meridian, Arizona and this
claim encompasses portions of the following quarter section(s), section(s), Township(s) and Range(s)
_____ Gila Salt River Base and Meridian, Arizona.

The locality of this claim with reference to some natural object or permanent monument and additional
information (if any) concerning its locality are as follows: The Northeast corner of the claim is located
3114 ft SWbW from the NE corner of Section 15

DATED AND POSTED on the ground this 10th day of October, 2018.

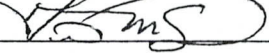
LOCATOR(s) Travis Snider 

ANC452456

When recorded, please refer to:
Destiny Resources LLC
4493 E. Whitehall Drive,
San-Tan Valley, AZ 85140

MINING CLAIM MAP

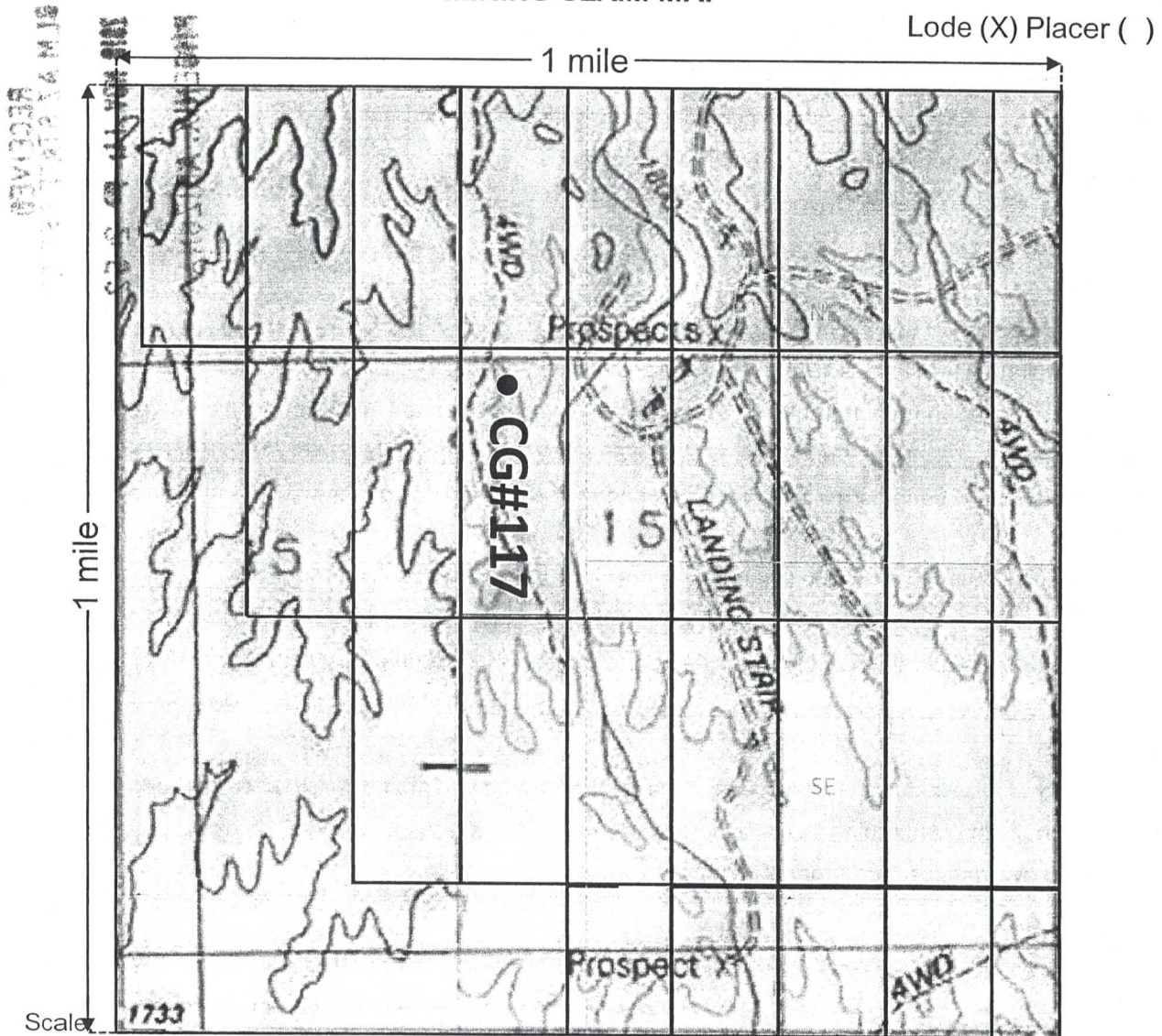

1" = 2000 feet

1. The above map depicts the CG#117 mining claim, which is located in Section(s) 15, Township 13 S, Range 6 W, Gila and Salt River Base and Meridian, Pima County, Arizona.
2. The type of corner and location monuments used are as follows: 2" PVC Pipe or 2 1/2" Wooden
3. The bearings and distances in degrees and feet between claim corners are as depicted on the map.



LR2000 Internal

CR Geographic Report with Land

[Download User Guide \(pdf\)](#)

Purpose: This report produces a geographic listing of case information based on retrieval by Meridian/Township/Range. This report format will display the case type, case disposition, meridian, township, range, section, survey type, survey number, surface management agency, pending actions, serial number, and total case acres.



No Results

The specified criteria didn't result in any data. This is often caused by applying filters and/or selection steps that are too restrictive or that contain incorrect values. Please check your analysis filters and selection steps, and try again. The filters or selection steps currently being applied are shown below.

Filters

Disposition is equal to **AUTHORIZED, CANCELLED, EXPIRED, PENDING, REJECTED, RELINQUISHED, WITHDRAWN**
and Meridian Township Range Section is equal to **14 00130S 0060W 015**
and Admin State is equal to **AZ**

[Return - Refresh](#)

Snyder
16201 E. Bai
Fountain Hills

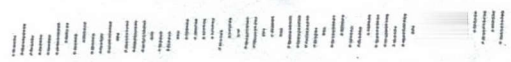

RECEIVED
BLM AZ STATE OFFICE
2018 NOV 14 P 2:52
PHOENIX, ARIZONA

West Valley P&DC
MON 12 NOV 2018 PM



BLM Mining Claim
1 N. Central Ave. Suite 800
Phoenix, Az 85004